



**RESERVE
YOURS
NOW!**

Pictured: Artists impression of Elizabeth House



ELIZABETH HOUSE

1-26, 1 Christopher Road, East Grinstead RH19 3BT

An exclusive redevelopment of quality one and two bedroom apartments in the heart of East Grinstead.

Show flat viewings by appointment only

Another quality
development by
WHITEHALL
HOMES



ELIZABETH HOUSE

1-26, 1 Christopher Road, East Grinstead RH19 3BT



Pictured: Artists impression of Elizabeth House



1 bed apartments from
£201,500

2 bed apartments from
£239,500

Floorplan

Example of a 2 bed apartment*

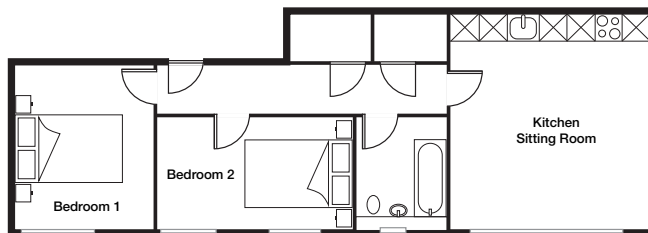

Features

- **Kitchen:** Modern and quality Cashmere, Gloss White or Cream kitchens available with built-in appliances
- **Lighting:** LED down-lights in kitchen, hallways and bathrooms
- **Bathrooms:** Contemporary suite with porcelain floor tiles
- **Flooring:** Real-wood oak flooring to hallway and lounge. Tiled kitchen, carpeted bedrooms
- **Joinery:** Internal oak doors. PVC double-glazed windows & patio doors
- **Parking & Garages:** Available (selected flats)

Agent details



Tel: 01342 410227



Tel: 01342 311711



Tel: 01342 314156



*Example layout only. Floor plans may vary depending on apartment specification.